



TITAN[®]

ACCESSORIES





OUR MISSION

When your business depends on the tools you use,
you need to be able to count on the people who make them.

Our relentless commitment to helping every professional painter
be their best leads to better work, improved ROI and growing business.

T

All information contained in this brochure is based on the latest information available at the time of printing. Titan reserves the right to make changes at any time, without notice. Due to continuous innovation, specifications may progressively change. Contact one of our dependable sales reps or call our dedicated customer service team for more information.



TITAN[®]

ACCESSORIES

04 AIRLESS GUNS

An industry leader in spray gun technology – Titan offers a full line of the best quality airless guns for every application imaginable.

08 AIRLESS TIPS

Titan offers a full range of spray tips for a full range of applications.

14 GUN ACCESSORIES

Titan has a guard for every tip and the best paint filters available. And if your arms just aren't long enough we have a reach tool or gun extension.

18 ROLLERS

Our rollers have the speed of a sprayer and the control of a roller.

20 AIRLESS HOSES

Designed to withstand time and pressure, Titan's full line of airless hoses will have you covered for every job.

22 FITTINGS

Need more hose length or need to alter the angle of the hose connected to the sprayer? You need Titan manifolds and fittings.

24 LIQUIDS

Titan has all the products you need to keep your equipment/accessories clean and functioning in top condition.

26 LINE STRIPING

Check out our hard working assortment of accessories devoted specifically to pavement and turf marking.

28 HVLP ACCESSORIES

For contractors and finishing professionals that expect flawless results. We have the tools for the perfect finish.

30 AIRSPRAY GUNS

A broad range of pressure pots, cups, guns and accessories that allow applicators to deliver a perfect finish the first time—every time.

THE INDUSTRY LEADER IN SPRAY GUN TECHNOLOGY

Countless hours of research and development have been devoted to manufacturing a full line of the best quality Titan airless guns for every application imaginable - from the thinnest lacquers to the heaviest architectural and commercial grade coatings.

LX-80^{II} Airless Gun

The LX-80^{II} airless gun features all-metal construction and is available in either 2 or 4-finger trigger. The Tungsten Carbide ball valve and seat will ensure long life and durability.

- In-handle filter reduces clogging and increases tip life
- Swivel reduces hose kinks and assures effortless control
- Pressure rated at 3600 PSI (24.8 MPa)

DESCRIPTION	PART NO.
LX-80 ^{II} 4-Finger Gun with SC-6+ Tip	580-100A
LX-80 ^{II} 4-Finger Gun with TR ² Tip	580-500
LX-80 ^{II} 2-Finger Gun with SC-6+ Tip	581-085
LX-80 ^{II} 4-Finger Gun, Hose and SC-6+ Tip Kit	580-050
LX-80 ^{II} 2-Finger Gun, Hose and SC-6+ Tip Kit	581-050
LX-80 ^{II} Repair Kit	580-034A



LX-80^{II} ■
Airless Gun

LX-40 Airless Gun 550-540

- All metal construction
- In-handle filter
- Tungsten carbide ball valve ensures long life
- Includes 517 TR¹ reversible tip
- Pressure rated at 3000 PSI (20.7 MPa)



LX-40 ■
Airless Gun

LX-50 Airless Gun 0286021

- All metal construction
- In-handle filter
- Tungsten carbide ball valve ensures long life
- Includes 517 TR¹ reversible tip
- Pressure rated at 3000 PSI (20.7 MPa)



LX-50 ■
Airless Gun



Introducing the **RX-PRO™** AIRLESS SPRAY GUN

We are redefining spraying with a customizable spray gun that delivers more comfort and control than you ever thought possible.



Infinity Packing™
2X the gun life by reversing the seat and changing the ball.



FingerPrint Grip™
Customize the grip to comfortably fit any painter's hand.



Ultra-Light Trigger
5 lbs. lighter than the competitors trigger pull decreasing fatigue.



Onboard Tools
Smart tools that make jobsite life easier.

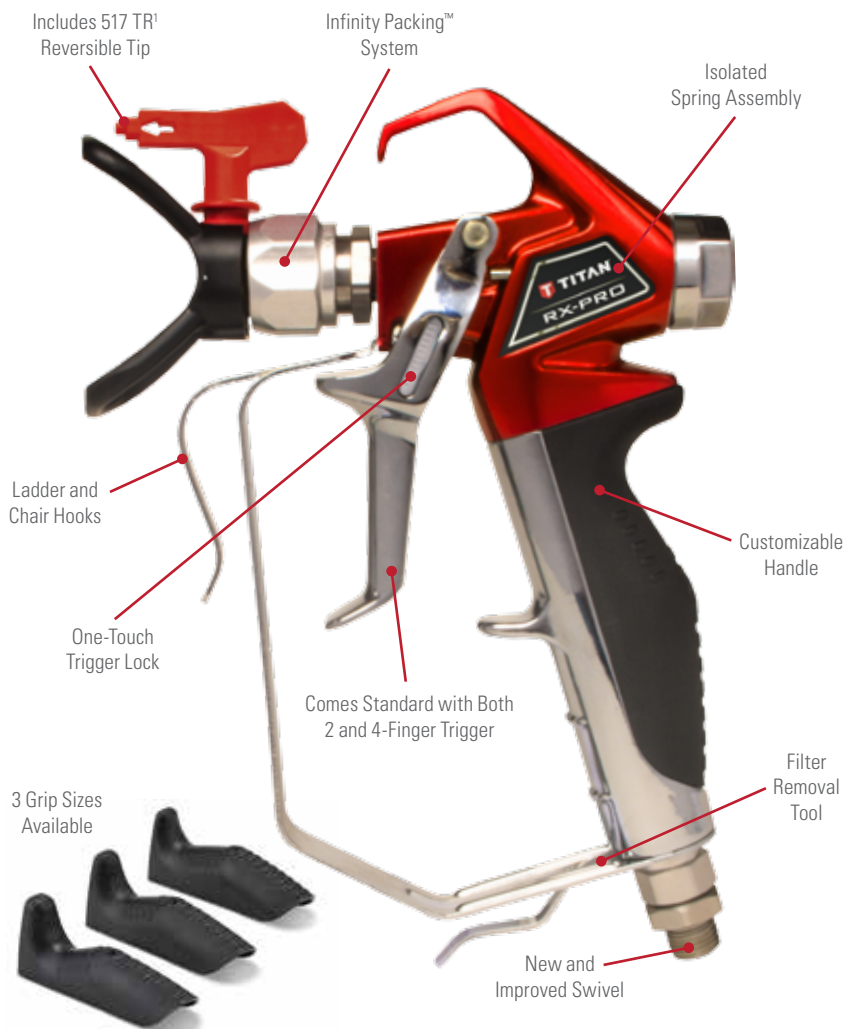

RX-Pro™ FingerPrint Grip™
Customizable to your hand size.

DESCRIPTION	PART NO.
Small	0538217
Medium	0538218
Large	0538219

- Comes with both 2 and 4-finger trigger
- Pressure rated at 3600 PSI (24.8 MPa)

DESCRIPTION	PART NO.
RX-Pro Airless Gun with SC-6+ Tip	0538021
RX-Pro Airless Gun, Hose and SC-6+ Tip Kit*	0538023

*Includes additional a 3' whip hose.



HANDLE SPECIALIZED COATINGS WITH EASE

Titan S-Series stainless steel spray guns hold up under extreme pressure and built for contractors that need to spray at pressures from 3900 PSI to 7700 PSI. The S-Series can handle corrosive coatings due to the stainless steel fluid passage. The Tungsten Carbide ball valve and seat will ensure long life and durability. Just pull the trigger and the Titan S-Series spray guns will deliver an excellent finish.

S-3 Airless Gun

- In-handle filter
- Easy 4-finger trigger pull
- 1/4" swivel reduces hose kinks
- Pressure rated at 3900 PSI (26.9 MPa)

DESCRIPTION	PART NO.
S-3 Gun with SC-6+ Tip	550-250
S-3 Gun, Hose and Tip Kit	550-460
S-3 Repair Kit	550-275

S-5 Airless Gun

- Stainless steel fluid passages
- Front feed, filter-less design for heavy coatings
- Easy 2-finger trigger pull
- Pressure rated at 5000 PSI (34.5 MPa)

DESCRIPTION	PART NO.
S-5 Gun with SC-6+ Tip	550-100
S-5 Gun, Hose and Tip Kit	550-110
S-5 Repair Kit	520-025

S-7 Airless Gun

- In-handle filter
- Available in two swivel sizes
- Easy 4-finger trigger pull
- Swivel reduces hose kinks
- Includes 517 TR¹ high pressure, heavy-duty reversible tip
- Pressure rated at 7700 PSI (53.1 MPa)

DESCRIPTION	PART NO.
S-7 Gun with 1/4" Swivel	550-260
S-7 Gun with 3/8" Swivel	550-270
S-7 Repair Kit	550-276



■ S-3 Airless Gun



■ S-5 Airless Gun



■ S-7 Airless Gun

FROM FINE FINISHING TO THE HARSHTEST COATINGS

From the harshest coatings (Mastic Guns) to detailed fine finish work (GM 3600) Titan has a gun that fits your needs.



GM 3600 Gun

M-4 Mastic Gun

M-4 and M-8 Mastic Guns

- Straight line fluid passage allows max flow rate
- Angled handle for increased comfort
- Adjustable needle packing prolongs the life of critical wear parts
- Swivel allows freedom of movement without hose kinking
- Lightweight metal construction

DESCRIPTION	PSI	PART NO.
M-4 Mastic Gun	3600 (24.8 MPa)	0289013
M-8 Mastic Gun	7700 (53.1 MPa)	0289014

GM 3600 Gun

This air-assisted airless gun works with both standard reversible tips and Brilliant™ Flat Tips. It offers ergonomic comfort and a reversible tip system without sacrificing finish quality.

- Inline filter for clean coatings
- Stainless steel fluid passages
- Pressure rated at 3600 PSI (24.8 MPa)

DESCRIPTION	PART NO.
3600 AirCoat Gun with Reversible Tip Guard	0524357
Air Cap Assembly for Reversible Tip	0524359
3600 AirCoat Gun with Flat Tip Guard*	0524358
Air Cap Assembly for Flat Tip	0524360
AirCoat Test Air Cap Kit	0524229

*Includes 9/20 Flat Tip.

BRILLIANT™ FLAT TIP SIZES (For GM 3600 Gun)

DESIGNATION	ORIFICE DIAMETER	ANGLE	RECOMMENDED FILTER	PART NO.
9/20	0.009	20	180 Mesh	0526209
9/40	0.009	40	180 Mesh	0526409
11/10	0.011	10	180 or 100 Mesh	0526111
11/20	0.011	20	180 or 100 Mesh	0526211
11/40	0.011	40	180 or 100 Mesh	0526411
13/10	0.013	10	100 Mesh	0526113
13/20	0.013	20	100 Mesh	0526213
13/40	0.013	40	100 Mesh	0526413
15/10	0.015	10	100 Mesh	0526115
15/20	0.015	20	100 or 50 Mesh	0526215
15/40	0.015	40	100 or 50 Mesh	0526415
17/20	0.017	20	50 Mesh	0526217
17/40	0.017	40	50 Mesh	0526417

For Textured Applications

Splatter Nozzle 765-360

Add the splatter nozzle to any airless spray gun for smooth texture applications including orange peel and knock down. For best results use with S or M Series Airless Guns.



THE INDUSTRY LEADER IN TIP TECHNOLOGY

Airless spray tips are a key component to the successful operation of an airless spray system. They define the spray pattern, control the flow, atomize the coating and ultimately tell the pump how hard it must work. A proper understanding of airless tips is critical to the success of any airless application.



Tip Characteristics

It is important to remember that the orifice size, in conjunction with the fan-width, determines the spray characteristics of the tip.

Tip Wear

When beginning a project, choosing the right tip size and fan width will determine both coating consumption and production time. If the tip size is wrong — by either choice or through wear — mil thicknesses will be too heavy and the finish will be unprofessional.

The spray pattern chart demonstrates what happens as a tip wears. As wear occurs, the pattern size decreases and the orifice size increases. You will have to make more passes to cover the same area. There is no standard rate of tip wear due to the variation of the abrasiveness of all coatings.

Examples for Understanding Airless Tips

Example A:

The larger the orifice with the same fan width, the greater the volume of paint applied to the area.

Fan Width:	10"	10"	10"
Orifice Size:	.017	.021	.026
Tip Number:	517	521	526
	Least Volume	More Volume	Most Volume

Example B:

The larger the fan width with the same orifice means the same amount of material is being applied over a greater area. The result is less volume of paint per square inch.

Fan Width:	8"	12"	16"
Orifice Size:	.017	.017	.017
Tip Number:	417	617	817
	Least Volume	More Volume	Most Volume

How a Tip Fan Pattern Typically Wears

SC-6+ WITH 517 TIP			
SPRAY PATTERN WIDTHS			
New 517	Worn to 419	Worn to 321	Worn to 223
FLOW RATES			
.31 gpm (1.17 lpm)	.39 gpm (1.47 lpm)	.47 gpm (1.78 lpm)	.57 gpm (2.15 lpm)
FLOW RATE INCREASE			
0%	26%	52%	84%

TR ¹ WITH 517 TIP			
SPRAY PATTERN WIDTHS			
New 517	Worn to 519	Worn to 521	Worn to 523
FLOW RATES			
.31 gpm (1.17 lpm)	.39 gpm (1.47 lpm)	.47 gpm (1.78 lpm)	.57 gpm (2.15 lpm)
FLOW RATE INCREASE			
0%	26%	52%	84%



SC-6+

HIGH QUALITY

The SC-6+ tip has the industry's longest lasting orifice.

- Up to 22% wider fan pattern
- Fits all Titan and most industry standard guards

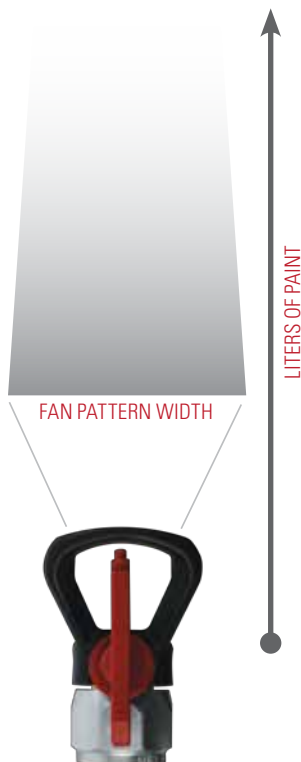

TR²

VERSATILE

The TR² is one tip with two fan patterns. Switch from wide or narrow fan patterns with a simple twist.

- Speed and control at your fingertips
- Consistent film thickness when using wide or narrow fan pattern

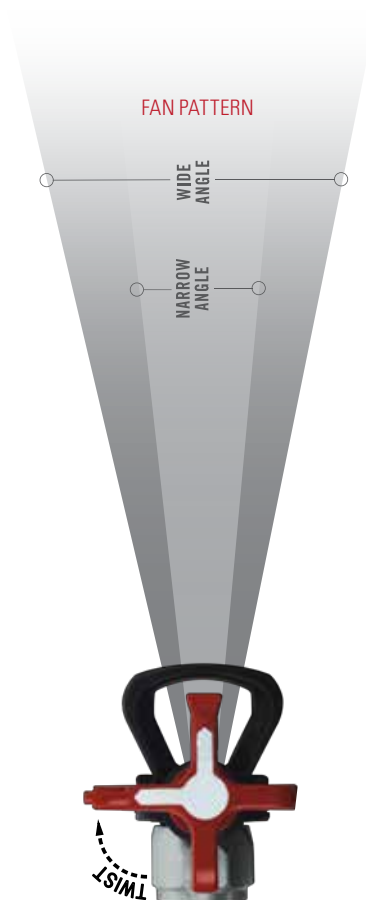

PREMIUM

TR¹ REVERSIBLE TIP

- The best overall performing tip in the industry
- Fan pattern stays wider longer
- An orifice that outlasts competitive tips delivering consistent film thickness and less wasted paint
- Fits all Titan and most other industry spray gun guards

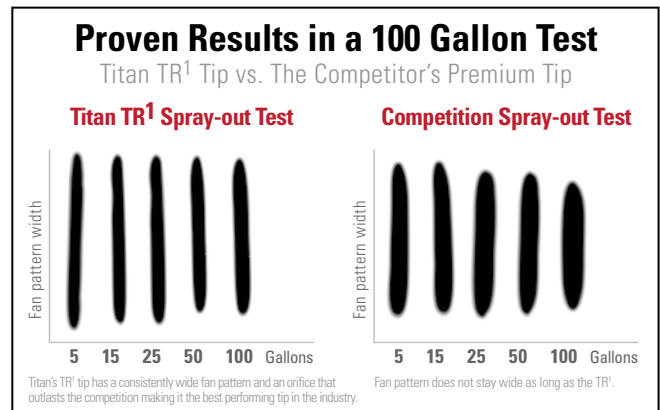

TR¹ High Pressure Tips 696-XXX

			ORIFICE SIZE (INCHES)																							
FAN PATTERN WIDTH	INCHES	MM	0.007	0.009	0.011	0.013	0.015	0.017	0.019	0.021	0.023	0.025	0.027	0.029	0.031	0.033	0.035	0.037	0.039	0.041	0.043	0.045	0.051	0.055	0.061	
	2–4	51–102	107	109	111	113	115	117	119																	
	4–6	102–152	207	209	211	213	215	217	219	221	223	225	227													
	6–8	152–203	307	309	311	313	315	317	319	321	323	325	327	329	331	333	335	337	339						361	
	8–10	203–254		409	411	413	415	417	419	421	423	425	427	429	431	433	435	437	439		443	445	451	455		
	10–12	254–305		509	511	513	515	517	519	521	523	525	527	529	531	533	535	537	539		543	545	551	555		
	12–14	305–356		609	611	613	615	617	619	621	623	625	627	629	631	633	635	637	639	641	643	645	651	655		
	14–16	356–406			711	713	715	717	719	721	723	725	727		731	733	735									
	16–18	406–457				813	815	817	819	821	823	825	827	829	831		835	837	839							
	18–20	457–508									923	925	927		931			937								
	Flow (GPM)	---	0.05	0.09	0.13	0.18	0.24	0.31	0.39	0.47	0.57	0.67	0.78	0.91	1.03	1.17	1.32	1.40	1.64	1.81	1.99	2.18	2.91	3.26	4.14	
	Flow (LPM)	---	0.19	0.34	0.45	0.68	0.91	1.17	1.47	1.78	2.15	2.53	2.95	3.44	3.89	4.42	4.99	5.29	6.20	7.18	7.52	8.24	11.00	12.32	15.65	

Maximum Working Pressure: 7700 PSI (53.1 MPa)

TR¹ Line Stripping Tips 697-XXX

			ORIFICE SIZE (INCHES)												
FAN PATTERN WIDTH	INCHES	MM	0.013	0.015	0.017	0.019	0.021	0.023	0.025	0.027	0.029	0.031	0.035	0.039	0.043
	2	51	213	215	217	219									
	4	102	413	415	417	419	421	423	425	427	429	431	435	439	443
	6	152		615	617	619	621	623	625	627	629	631	635	639	643
	8–10	203–254					821	823	825	827	829	831	835	839	843
	Flow (GPM)	---	0.18	0.24	0.31	0.39	0.47	0.57	0.67	0.78	0.91	1.03	1.32	1.64	1.99
	Flow (LPM)	---	0.68	0.91	1.17	1.47	1.78	2.15	2.53	2.95	3.44	3.89	4.99	6.20	7.52

Maximum Working Pressure: 5000 PSI (34.5 MPa)



HIGH QUALITY SC-6+ REVERSIBLE TIP

- The industry's longest lasting orifice
- Up to 22% wider fan pattern
- Fits all Titan and most industry standard guards

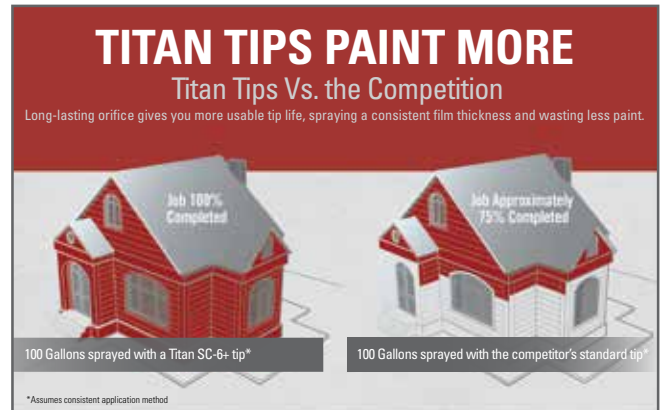

SC-6+ Tips 662-XXX

		ORIFICE WIDTH (INCHES)																				
FAN PATTERN WIDTH	INCHES	MM	0.007	0.009	0.011	0.013	0.015	0.017	0.019	0.021	0.023	0.025	0.027	0.029	0.031	0.033	0.035	0.039	0.043	0.045	0.051	0.055
	2–4	51–102	107	109	111	113	115	117														
	4–6	102–152	207	209	211	213	215	217	219	221	223	225	227	229	231	233	235					
	6–8	152–203	307	309	311	313	315	317	319	321	323	325	327	329	331	333	335					
	8–10	203–254	407	409	411	413	415	417	419	421	423	425	427	429	431	433	435	439	443	445	451	455
	10–12	254–305		509	511	513	515	517	519	521	523	525	527	529	531	533	535	539	543	545	551	555
	12–14	305–356		609	611	613	615	617	619	621	623	625	627	629	631	633	635	639	643	645	651	655
	14–16	356–406							719	721					731		735					
	16–18	406–457								821					831							
	Flow (GPM)	---	0.05	0.09	0.12	0.18	0.24	0.31	0.39	0.47	0.57	0.67	0.78	0.91	1.03	1.17	1.32	1.64	1.99	2.18	2.80	3.26
	Flow (LPM)	---	0.19	0.34	0.45	0.68	0.91	1.17	1.47	1.78	2.15	2.53	2.95	3.44	3.89	4.42	4.99	6.20	7.52	8.24	10.58	12.32

Maximum Working Pressure: 5000 PSI (34.5 MPa)

SC-6+ Widespray Tips 661-XXX

			ORIFICE SIZE (INCHES)									
FAN PATTERN WIDTH	INCHES	MM	0.019	0.021	0.023	0.025	0.027	0.029	0.031	0.033	0.035	0.037
	24–26	610–660	1219	1221	1223	1225	1227	1229	1231	1233	1235	1237
	Flow (GPM)	---	0.39	0.47	0.57	0.67	0.78	0.91	1.03	1.17	1.32	1.47
	Flow (LPM)	---	1.47	1.78	2.15	2.53	2.95	3.44	3.89	4.42	4.99	5.56

Maximum Working Pressure: 5000 PSI (34.5 MPa)



SC-6+ Synergy Fine Finishing Tips 671-XXX

		ORIFICE SIZE (INCHES)				
FAN PATTERN WIDTH	INCHES	MM	0.008	0.010	0.012	0.014
	4-6	102-152	208	210	212	214
	6-8	152-203	308	310	312	314
	8-10	203-254	408	410	412	414
	10-12	254-305		510	512	
	12-14	305-356			612	
	Flow (GPM)	---	0.07	0.11	0.16	0.21
	Flow (LPM)	---	0.26	0.42	0.60	0.79

Maximum Working Pressure: 5000 PSI (34.5 MPa)



VERSATILE TR² REVERSIBLE TIP

- One tip with two fan patterns
- Switch to wide or narrow fan pattern with a twist
- Speed and control at your fingertips
- Consistent film thickness when using wide or narrow fan pattern

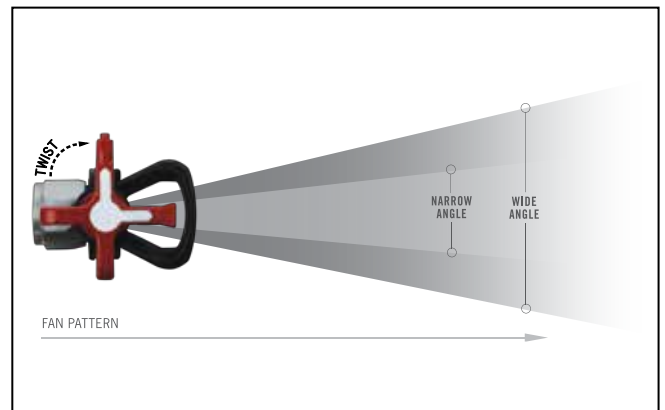

TR² Tips 692-XXX

		ORIFICE SIZE (INCHES)										
FAN PATTERN WIDTH	INCHES	MM	0.011	0.013	0.015	0.017	0.019	0.021	0.023	0.027	0.031	0.035
	6–8	152–203	311	313								
	8–10	203–254			415	417						
	10–12	254–305			515	517	519	521				535
	12–14	305–356								627		635
	16–18	406–457									831	
	24–26	610–660							1223		1231	
	Flow (GPM)	---	0.12	0.18	0.24	0.31	0.39	0.47	0.57	0.78	1.03	1.32
	Flow (LPM)	---	0.45	0.68	0.91	1.17	1.47	1.78	2.15	2.95	3.89	4.99

Maximum Working Pressure: 5000 PSI (34.5 MPa)

TR² Fine Finishing Tips 693-XXX

			ORIFICE SIZE (INCHES)		
FAN PATTERN WIDTH	INCHES	MM	0.010	0.012	0.014
	10–12	254–305	510	512	514
	Flow (GPM)	---	0.11	0.16	0.21
	Flow (LPM)	---	0.42	0.60	0.79

Maximum Working Pressure: 5000 PSI (34.5 MPa)

TR² Line Striping Tips

From striping to stenciling – with the twist of the tip.

STRIPING TIP SIZE	STENCIL TIP SIZE	FLAG	FILTER COLOR	PART NO.
417	517	Yellow	White	694-1708517
419	519	Yellow	White	694-1908519
421	621	Yellow	White	694-2108621
423	623	Yellow	White	694-2308623

Collar Kit 0271065

Attach TR² tip to standard guard.



A FULL SPECTRUM OF SPRAY TIPS

FOR A FULL RANGE OF APPLICATIONS

Flat Tips 002-XXX

- Precision machined from the highest quality Tungsten Carbide
- Solvent-proof seal holds up against the harshest coatings
- PSI pressure rated to 5000 PSI (34.5 MPa)



		ORIFICE SIZE (INCHES)										
	INCHES	MM	.007	.009	.011	.013	.015	.017	.018	.019	.021	.023
FAN PATTERN WIDTH	2-4	51-102	107	109	111		115	117		119	121	
	4-6	102-152	207	209	211	213	215	217		219	221	225
	6-8	152-203		309	311	313	315	317	318	319	321	323
	8-10	203-254	407	409	411	413	415	417	418	419	421	423
	10-12	254-305	507	509	511	513	515	517	518	519	521	523
	12-14	305-356	607		611	613	615	617	618	619	621	623
	14-16	356-406				713	715	717		719	721	723
	16-18	406-457			811	813	815	817	818	819	821	823
	18-20	457-508				913	915		918			923
	20-22	508-559					1015	1017	1018		1021	
	22-24	559-610										
	24-26	610-660				1213	1215		1218		1221	1223
	26-28	660-711										
		Flow (GPM)	---	0.05	0.09	0.13	0.18	0.24	0.31	0.35	0.39	0.47
	Flow (LPM)	---	0.19	0.34	0.49	0.68	0.91	1.17	1.32	1.47	1.78	2.15

		ORIFICE SIZE (INCHES)																			
INCHES	MM	.025	.026	.027	.029	.031	.033	.035	.036	.039	.041	.042	.043	.047	.049	.052	.055	.058	.062	.072	
FAN PATTERN WIDTH	2-4	51-102																			
	4-6	102-152					231														
	6-8	152-203	325		327		331		336	339		342				352					
	8-10	203-254	425	426	427	429	431	433	435	436	439	441		443		449	452			472	
	10-12	254-305	525		527	529	531		535	536	539		543		549	552		558	562		
	12-14	305-356	625	626	627		631	633	635	636		641		643		652	655				
	14-16	356-406	725		727		731	733	735												
	16-18	406-457	825		827		831		835	836	839			843	847				862		
	18-20	457-508	925	926			931			936									962		
	20-22	508-559					1031														
	22-24	559-610								1136				1143							
	24-26	610-660		1226		1229	1231														
	26-28	660-711								1336											
	Flow (GPM)	---	0.67	0.73	0.78	0.91	1.03	1.17	1.32	1.40	1.64	1.81	1.90	1.99	2.38	2.58	2.91	3.26	3.62	4.14	5.58
	Flow (LPM)	---	2.53	2.76	2.95	3.44	3.89	4.42	4.99	5.29	6.20	6.84	7.18	7.52	9.00	9.75	11.00	12.32	13.68	15.65	21.09

Adjustable Self-Cleaning Tips 341-XXX

- Fully adjustable fan widths from 2" to 24" reduce overspray
- Perfect when changing from spraying walls to cutting in for trim work or around windows
- Self-cleaning feature eliminates costly downtime

ORIFICE RANGE	COATING RANGE	PART NO.
.005-.018	Lacquer and Stain	341-015
.007-.019	Lacquer and Stain	341-020
.007-.026	Lacquer and Enamels	341-024
.011-.026	Lacquer and Enamels	341-028
.017-.035	High Builds	341-041
.021-.054	Very Heavy	341-049



Metering Orifice 512-XXX

Designed to produce a more complete atomization of the spray pattern. Increases your transfer efficiency by allowing you to spray at lower pressures.

When ordering, always use a metering orifice that is at least .004 larger than the spray tip being used. Example: a .019 tip should be used with a .023 Metering Orifice.

ORIFICE - INCHES	MAX. RECOMMENDED TIP SIZE	PART NO.
.011	.007	512-011
.013	.009	512-013
.015	.011	512-015
.018	.013	512-018
.021	.017	512-021
.023	.019	512-023
.026	.021	512-026
.031	.026	512-031
.035	.031	512-035
.039	.035	512-039
.049	.043	512-049
.059	.045	512-59

A GUARD FOR EVERY TIP

Titan tip guards are designed to maximize airflow with minimal overspray. With a guard for every tip and the universal fitting which matches most industry standard guns we have you covered.



No Build Guard (7/8") 0289228

Aerodynamic dimple design allows for better airflow and less paint build up. Seal cavity on safety guard has large "flats" for quick and easy installation of seal.

- Rotate guard without loosening from gun
- No tools needed for installation
- Interchangeable with most industry spray guns
- Pressure rated at 5000 PSI (34.5 MPa)

High Pressure Tip Guard (7/8") 661-027

- Interchangeable with most industry spray guns
- Pressure rated at 7700 PSI (53 MPa)

Adjustable and Flat Tip Guard

- Interchangeable with most industry spray guns
- Pressure rated at 5000 PSI (34.5 MPa)



DESCRIPTION	PART NO.
7/8" - 14	450-100A
11/16" - 14 (Flat tips only)	0153003



Seals

DESCRIPTION	PART NO.
Metal Retainer	651-040
Black Seal, Latex	651-042
White Seal, Solvent Resistant	651-020
White Seal, Solvent Resistant (6-pack)	661-021
Seal and Retainer Kit, Solvent Resistant (5-pack)	661-020
Seal and Retainer Kit, Solvent Resistant (12-pack)	651-060
Gasket Kit, 1/8" (12-pack)	711-612
Gasket Kit, 1/16" (12-pack)	711-606

THE BEST FILTERS AVAILABLE

Nothing destroys a piston or a gun tip faster than debris in the coating. That's why you need the best paint filters available. Titan gun filters and manifold filters are designed for long life and maximum protection. They are made from stainless steel for strength and service. We offer a wide variety of mesh sizes from 0 to 150.

Gun and Pump Filters

Unthreaded filter design for quick and easy replacement.

For use with RX-Pro™, G-10, LX-30, LX-40, LX-50, LX-70, S-3 and S-7.

UNTHREADED		
FILTERS	BULK PART NO.	2-PACK PART NO.
Coarse (Green)*	581-059	0089957
Medium (White)	581-060	0089958
Fine (Yellow)	581-062	0089959
Extra Fine (Red)	581-061	0089960

*Manifold filter for Advantage 400.



For use with LX-80^{II} and LX-80 Platinum.

THREADED		
FILTERS	BULK PART NO.	2-PACK PART NO.
Coarse (Green)*	540-030	500-200-03
Medium (White)	540-060	500-200-06
Fine (Yellow)	540-100	500-200-10
Extra Fine (Red)	540-150	500-200-15

*Manifold filter for 440i and Impact 400.



 Pump Manifold Filters

Pump Manifold Filters

For use on Impact® 440–1140; 640ix–1140ix.

MESH	PART NO.
Coarse-30 Mesh	730-067-30
Medium-60 Mesh	730-067
Fine-100 Mesh	730-067-10

For use on PowrTwin™ 4900, 5500, 6900, 8900, 10000 and 12000 Plus.

MESH	PART NO.
Mastic-0 Mesh	930-004
Coarse-5 Mesh	930-005
Medium-50 Mesh*	930-006
Fine-100 Mesh	930-007

*Standard with sprayer. Includes ball.



For use on Hydra™, PowrTwin 3500 and 4500.

MESH	PART NO.
Coarse-5 Mesh	920-001
Medium-50 Mesh*	920-004
Fine-100 Mesh	920-005

*Standard with sprayer, excludes ball.
Ball check sold separately (920-103).

For use on all 10" PowrCoat™ models.

MESH	PART NO.
Medium-60 Mesh	0533514

For use on Titan E15, E20, G40 and G55.

MESH	PART NO.
Coarse-30 Mesh	761-042
Medium-60 Mesh	761-043

Pump Manifold Filter Plugs



MESH	PART NO.
Impact 400	0532357
Impact 440, 540, 640	0552934
Impact 740-1140 and 1200SF	0295281A

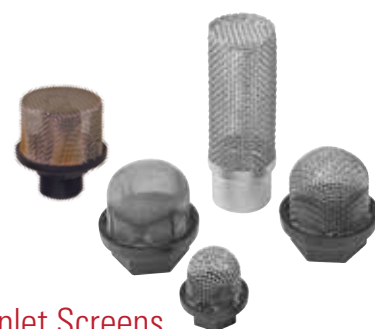

Inlet Screens

SMALL		
MESH	PART NO.	
30 mesh (Fine)	700-900	
10 mesh (Coarse)	700-805	
30 mesh (Male Thread)	0552947	

LARGE		
MESH	PART NO.	
30 mesh (Fine)	710-191	
10 mesh (Coarse)	710-046	

HYDRAULIC AND PNEUMATIC	
DESCRIPTION	PART NO.
PowrTwin 4900, 6900, 8900, 12000 Plus and XLT	0509762A
All GHD	710-046
Hydra Pro IV	0509762A
PowrCoat 10" (30 Mesh)	0533968

In-Line Filter 550-223

Designed for added filtration or when using a gun without a filter.



 In-Line Gun Filter

WHEN YOUR ARMS JUST AREN'T LONG ENOUGH

- Maximize the speed and efficiency of your operation
- Minimize danger – eliminate reaching from ladders
- Get the job done safely and quickly the first time
- Paint easily from a safe distance, keeping yourself and clothing clean



SprayGuide™ 0538900

May your lines be straighter and your profits greater! This unique free-wheeling disc glides smoothly over virtually every surface.

Cut-in around windows, doors, trim and more without time consuming prep work.

- Eliminates time consuming masking or cutting in with brush
- Attaches to a gun extension or an extension pole (sold separately) decreasing ladder work
- Pressure rated at 3600 PSI (24.8 MPa)

DESCRIPTION	PART NO.
SprayGuide™ Replacement Arm and Disk Only	0538902



Aluminum Gun Extensions

Our aluminum gun extensions are lightweight and easy to handle and can be used with most brands of airless spray guns.

- Pressure rated at 3600 PSI (24.8 MPa)

7/8" x 14 Thread is Standard

DESCRIPTION	PART NO.
6" (15 cm)	651-070
12" (30 cm)	651-071
18" (45 cm)	651-072
24" (60 cm)	651-073

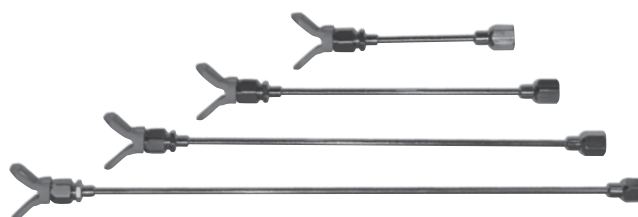

High Pressure, Stainless Steel Gun Extensions

When you need something a little more heavy duty. Can be used with most brands of airless spray guns.

- Pressure rated at 7700 PSI (53.1 MPa).

7/8" x 14 Thread is Standard

DESCRIPTION	PART NO.
6" (15 cm)	611-280
12" (30 cm)	611-281
18" (45 cm)	611-282
24" (60 cm)	611-283

Non-Spit Valve 0521012

Eliminate the spitting that occurs when spraying with pole extensions. Universal connection works with most industry extensions and guns.

- Pressure rated at 3600 PSI (24.8 MPa)





Swivel Head

Titan's swivel heads permit a 260° rotation for greater spraying versatility and accessibility. Use with Titan gun extensions and extension poles.

DESCRIPTION	PART NO.
7/8" x 14 Thread Swivel Head - Female	651-139
7/8" x 14 Thread Swivel Head - Male	711-600



Extension Pole

These lightweight aluminum extensions are constructed with inner core ribs which reinforce the pole and greatly increase their rigidity. The inner core rib construction allows different length poles to be easily coupled together up to 12', while maintaining the proper rigidity to suit most job conditions.

- Reach high out-of-the-way places when spray or pressure rolling
- Adapts to most airless guns
- Includes Extension Pole Coupling (310-062)
- Pressure rated at 3600 PSI (24.8 MPa)

DESCRIPTION	PART NO.
1.5' (0.46 m) Pole	310-381-1
3' (0.9 m) Pole	310-383-1
6' (1.8 m) Pole	310-386-1
3' Extension Pole with Swivel Head, 7/8" Nut	310-390
6' Extension Pole with Swivel Head, 7/8" Nut	0279976L

LX-70 In-Line Gun 550-475

- All metal construction
- A natural extension to any pole
- In-handle filter
- Swivel reduces hose kinks and ensures effortless control
- Pressure rate at 3600 PSI (24.8 MPa)

Repair Kit (550-487)



6' Outrigger 757-920

Convert existing gun to 6' (2 m) pole gun and back in seconds. Outrigger allows you to increase production and profits. No additional hoses or fittings required.

- Constructed of lightweight and rigid aluminum to reduce arm fatigue
- Large, gun installation holder and knob
- Adapts to all Titan airless spray guns and most manufacturers airless spray guns

LX-75 Pole Gun 550-495

Reach those high, out-of-the-way places that normally require the use of a ladder or scaffolding.

- All metal construction
- Full length needle ensures positive shut-off at tip
- Gun swivel
- In-handle filter
- Ergonomic design
- Pressure rated at 3600 PSI (24.8 MPa)

Repair Kit (550-487)



Angle Adapter Assembly



Extension Pole Coupling

Angle Adapter Assembly 0509907

Adapt any extension pole to any standard airless gun. Because of its right-angle design, the angle adapter allows the pole to extend from the gun at the same angle as the handle. The result is greater efficiency and comfort.

- Pressure rated at 3600 PSI (24.8MPa)

Extension Pole Coupling 0509908

Allows you to connect different length extruded poles together to create different lengths for any application. (Do not exceed 12')

THE SPEED OF A SPRAYER AND THE CONTROL OF A ROLLER

Every painting contractor has worked with a roller. It's an efficient and controlled way to apply paint. But it's also much slower than a sprayer – up to 40% of your labor time is spent charging the roller with paint. What if you could combine the two? Titan has the answer.



Inner-Feed Pressure Roller 310-934

Instead of dipping the roller into the paint, why not feed the paint into the roller? You get the best of both application worlds, increasing the speed and efficiency of your work – saving time and making a lot more money. It's much easier than you think and Titan has the equipment that lets you get the job done right.

- Up to 40% faster than standard roller application
- The roller never leaves the surface
- Easy to use and easy to clean up

Repair Kit (310-905)

Inner-Feed Pressure Roller Kit 310-150

Includes:

- 3' Pole
- 90° Angle Adapter
- Inner-Feed Roller head assembly
- 1/2" x 9" High Quality Inner Feed Roller Cover
- Fits onto any airless gun

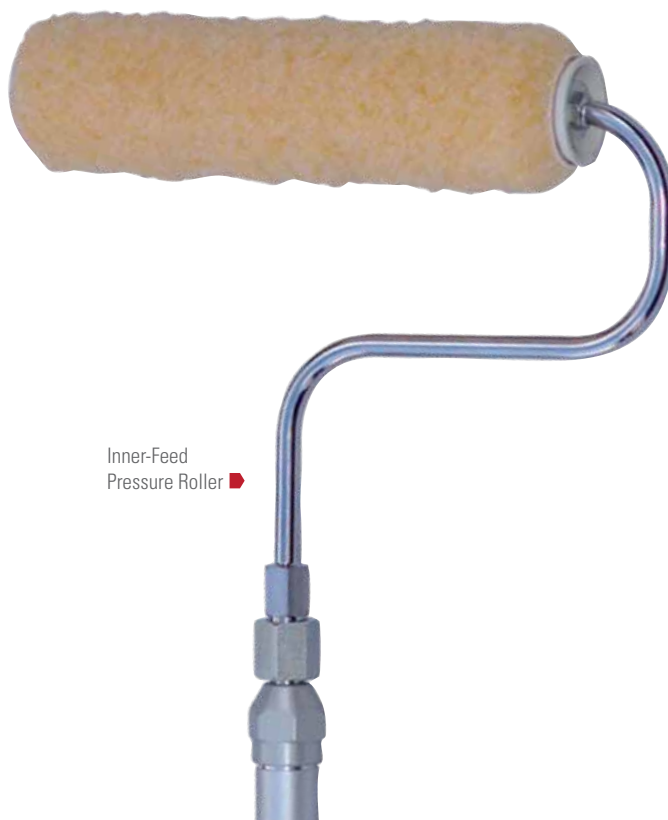

Inner-Feed Pressure Roller ■

Telescoping Pressure Roller (Low Pressure) 310-938

For high production paint applications where spraying is impractical. The patented auger head design evenly distributes coating for a professional finish every time. Includes lightweight aluminum adjustable pole with a working pressure of 1200 PSI (8.3 MPa).

- Quick pole adjustments from 3'-6' (0.9–1.8 m)
- Includes LX-70 In-Line Gun

LX-70 Telescoping Roller Kit 310-950

Includes:

- 9" (23 cm) Inner-Feed Roller Head
- 1/2" (1.30 cm) Nap

CAUTION! Do not use for spray applications.



Spray Roller 310-049

On rough, porous surfaces like stucco and concrete block many contractors apply the coating with a sprayer and then back-roll it into the surface. It can be messy (lots of overspray) and time consuming (you need two workers to do it). Now imagine what it would be like to spray AND roll at the same time. You save time and make money. That's what Titan is all about.

- Ideal for very porous and rough surfaces
- Spray on the down-stroke and roll on the upstroke
- Saves both time and money



3-in-1 Spray/Roll Application Kit 310-110

The Spray/Roll Application Kit offers the proper airless spray painting tools for just about every possible painting condition. It's the first complete application kit created for professionals. By selecting the proper combination of tools, the professional painter can choose to either spray, spray and back-roll or simply roll.

Includes:

- LX-70 In-Line Gun
- 9" (23 cm) Spray Roller Head Assembly
- 3' (9 m) Extruded Pole
- 9" (23 cm) Pressure Roller Head Assembly
- Swivel Head Assembly

Roller Head Replacement Covers

SPRAYER ROLLER REPLACEMENT COVERS

DESCRIPTION	NAP	PART NO.
9" (23 cm)	1/2" (1.20 cm)	311-050-9
9" (23 cm)	3/4" (1.90 cm)	311-075-9
9" (23 cm)	1-1/4" (3.10 cm)	311-125-9

INNER-FEED PRESSURE ROLLER REPLACEMENT COVERS

DESCRIPTION	NAP	PART NO.
9" (23 cm)	3/4" (1.90 cm)	312-075-9



THE RIGHT EQUIPMENT FOR THE JOB



High Quality Airless Fluid Hoses and Whip Hoses

I.D.	LENGTH		MAX. WORKING PRESSURE - PSI (MPa)					END CONNECTION
			3300 (22.8)	3600 (24.8)	4500 (31.0)	6500 (44.8)	7500 (51.7)	
	FEET	METERS	PART NO.	PART NO.	PART NO.	PART NO.	PART NO.	
1/8"	3	0.9	---	---	0290685	---	---	1/4" NPSM (F/M)
3/16"	3	0.9	0291004	---	---	---	---	1/4" NPSM (F/M)
	5	1.5	316-506	---	---	---	---	1/4" NPSM (F/M)
	9	2.7	550-222	---	---	---	---	1/4" NPSM (F/M)
	25	7.6	0291007	---	---	---	---	1/4" NPSM (FBE)
	50	15.2	0291008	---	---	---	---	1/4" NPSM (FBE)
1/4"	3	0.9	---	---	250450003	250650003	250750003	1/4" NPSM (FBE)
	6	1.8	316-533*	---	250450006	250650006	250750006	1/4" NPSM (FBE)
	6	1.8	550-227	---	---	---	---	1/4" NPSM (F/M)
	25	7.6	316-513	---	---	---	---	1/4" NPSM (FBE)
	50	15.2	316-505	0286498	250450050	250650050	250750050	1/4" NPSM (FBE)
	100	30.5	---	---	250450010	250650010	250750010	1/4" NPSM (FBE)
3/8"	3	0.9	---	---	375450003	375650003	375750003	3/8" NPSM (FBE)
	6	1.8	---	---	375450006	375650006	375750006	3/8" NPSM (FBE)
	25	7.6	0508342	---	---	---	---	3/8" NPSM (FBE)
	50	15.2	690-375-50	0286499	375450050	375650050	375750050	3/8" NPSM (FBE)
	100	30.5	---	---	375450010	375650010	375750010	3/8" NPSM (FBE)
1/2"	25	7.6	225-112*	---	---	---	---	1/2" NPSM (FBE)
	50	15.2	250-112*	---	500450050	500650050	500750050	1/2" NPSM (FBE)
	100	30.5	---	---	500450010	500650010	500750010	1/2" NPSM (FBE)

*Textile Braid. Spring guards at both ends.

FBE Female Both Ends, NPT National Pipe Tapered Thread, MBE Male Both Ends, NPSM National Pipe Straight Mechanical Thread, F/M 1 Female / 1 Male Connection



It's now easy to find the proper high pressure hose.

High Pressure Airless Hoses

Our new high pressure hoses are color-coded by pressure rating, making it easier to organize, identify and purchase.

First 3 digits indicate fitting or thread size, next 4 digits indicate max. PSI rating, last 2 digits indicate length.

I.D.	FIRST 3	PRESSURE	NEXT 4	LENGTH	LAST 2
1/4"	250	4500	4500	3	03
3/8"	375	6500	6500	6	06
1/2"	500	7500	7500	50	50

250 4500 50

Example: 1/4" X 50' 4500 PSI hose will be P/N 250450050

Hose Shield 0521424

Protect your airless hose from paint and abrasion damage with a durable 4 mil poly hose cover. Comes in 1100' lengths with perforation every 5' to fit any length of hose. Works with 1/4" and 3/8" hoses.



Hose sold separately.



Reel-EZ Hose Reels

Eliminate hose hassles while increasing your production. Both models mount to most major manufacturer's paint sprayers with similar designs.

- The 16" Cart-Mount holds up to 100' (30.5 m) of 1/4" airless hose
- The 10" Skid-Mount holds up to 50' (15.2 m) of 1/4" airless hose
- Pressure rated at 3600 PSI (25 MPa)

Fits handles/carts 3/4" to 1-1/2" in diameter.

DESCRIPTION	PART NO.
16" Cart-Mount	769-100
10" Skid-Mount	769-200



High Pressure Swivels

- Decreases resistance while spraying reducing overall fatigue
- Reduces hose kinking
- Pressure rated at 5000 PSI (34.5 MPa)

DESCRIPTION	PART NO.
Gun-to-Hose / Hose-to-Pump 1/4" (0.63 cm) NPS (F) x 1/4" (0.63 cm) NPS (M)	0509985
Hose-to-Hose 1/4" (0.63 cm) NPS (M) x 1/4" (0.63 cm) NPS (M)	0502135



Air Spray Hoses

DESCRIPTION	PART NO.
25' x 3/8" Air (Red)	0550893
30' x 3/8" Air (Red)	0295689
50' x 3/8" Air (Red)	0550891
25' x 1/4" Fluid (Black)	0550894
50' x 1/4" Fluid (Black)	0550892
30' x 3/8" Fluid (Black)	0277348
50' x 3/8" Fluid (Black)	0275281
4' Twin Hose	0552302
25' Twin Hose	0552303

Air Assisted Airless Spray Hoses

DESCRIPTION	PART NO.
25' Bonded Hose	9984595
50' Bonded Hose	0524333
4' 6" Air Whip Hose	0550860
5' Fluid Whip Hose	0550861

High Pressure Fluid Gauge Kit 0508239

Includes: 5000 PSI (34.5 MPa) high pressure fluid gauge attached to a T-Fitting with one 1/4" (M)(.63cm) fitting & one 1/4" (F)(.63cm) fitting.

- Fluid Gauge Only (0508626)
- Fluid Gauge Kit 3/8 (730-420A)
- Fluid Gauge Only (0508626)
- Fluid Gauge Kit 1/4 (0508239)



A FITTING FOR EVERY JOB

Spraying is more than just hooking up a hose. Sometimes the situation calls for extending hose length or altering the angle of the hose connected to the sprayer. That's when you need Titan manifolds and fittings. Our fittings are manufactured from quality stainless steel and engineered for durability and long life.

Couplings

HOSE TO HOSE	
DESCRIPTION	PART NO.
1/4" NPS(M) x 1/4" NPS(M)	05045
1/4" NPT(M) x 3/8" NPS(M)	812-003
3/8" NPS(M) x 3/8" NPS(M)	490-014
1/2" NPT(M) x 1/2" NPS(M)	449-621

Maximum Working Pressure: 5000 PSI (34.5 MPa)



HIGH PRESSURE HOSE TO HOSE	
DESCRIPTION	PART NO.
1/4" NPTF (M) x 1/4" NPTF(M)	9885642
3/8" NPTF (M) x 3/8" NPTF(M)	9885643
1/2" NPTF (M) x 1/4" NPTF(M)	9885644
3/4" NPTF (M) x 1/2" NPTF(M)	9885645
3/8" NPTF (M) x 1/4" NPTF(M)	9885646
1/2" NPTF (M) x 3/8" NPTF(M)	9885647
1/2" NPTF (M) x 1/2" NPTF(M)	9885648

Maximum Working Pressure: 7500 PSI (51.7 MPa)



MANIFOLD TO MANIFOLD	
DESCRIPTION	PART NO.
1/4" NPT(M) x 1/4" NPT(M)	490-002
1/4" NPT(M) x 3/8" NPT(M)	490-006
3/8" NPT(M) x 3/8" NPT(M)	814-004
3/8" NPT(M) x 1/2" NPT(M)	814-005
1/2" NPT(M) x 1/2" NPT(M)	814-006
1/2" NPT(M) x 3/4" NPT(M)	101-201
3/4" NPT(M) x 3/4" NPT(M)	814-007

Maximum Working Pressure: 5000 PSI (34.5 MPa)



MANIFOLD TO HOSE	
DESCRIPTION	PART NO.
1/8" NPT(M) x 1/4" NPS(M)	490-001
1/4" NPT(M) x 1/4" NPS(M)	227-006
1/4" NPT(M) x 3/8" NPS(M)	804-555
1/4" NPT(M) x 1/2" NPS(M)	814-003
3/8" NPT(M) x 1/4" NPS(M)	812-003
3/8" NPT(M) x 3/8" NPS(M)	808-555
3/8" NPT(M) x 1/2" NPS(M)	815-005
1/2" NPT(M) x 1/2" NPS(M)	228-002
3/4" NPT(M) x 1/2" NPS(M)	814-555

Maximum Working Pressure: 5000 PSI (34.5 MPa)



90° Street Elbows

DESCRIPTION	PART NO.
3/8" NPT(F) x 3/8" NPT(M)	818-002
1/2" NPT(F) x 1/2" NPT(M)	818-003
3/4" NPT(F) x 3/4" NPT(M)	818-010

Maximum Working Pressure: 5000 PSI (34.5 MPa)



Reducer Bushings

DESCRIPTION	PART NO.
3/8" NPT(M) x 1/4" NPT(F)	817-001
1/2" NPT(M) x 1/4" NPT(F)	929-061
1/2" NPT(M) x 3/8" NPT(F)	541-009
3/4" NPT(M) x 1/4" NPT(F)	929-062
1" NPT(M) x 3/4" NPT(F)	929-076
1-1/4" NPT(M) x 1" NPT(F)	929-077

Maximum Working Pressure: 5000 PSI (34.5 MPa)



Pipe Tees

DESCRIPTION	PART NO.
1/4" NPT(F)	970-023
3/8" NPT(F)	817-002
1/2" NPT(F)	817-003
3/4" NPT(F)	817-004

Maximum Working Pressure: 5000 PSI (34.5 MPa)



Swivel Unions

DESCRIPTION	PART NO.
1/4" NPS(F) x 1/4" NPT(M)	490-005
3/8" NPS(F) x 1/4" NPT(M)	490-042
1/4" NPS(F) x 3/8" NPT(M)	490-032
3/8" NPS(F) x 3/8" NPT(M)	490-043
1/2" NPS(F) x 1/2" NPT(M)	200-555
3/4" NPS(F) x 3/4" NPT(M)	138-037
1" NPS(F) x 1" NPT(M)	200-556

Maximum Working Pressure: 5000 PSI (34.5 MPa)



Pipe Plugs

DESCRIPTION	PART NO.
1/8" NPT(M)	227-030
1/4" NPT(M)	227-027
3/8" NPT(M)	227-033
1/2" NPT(M)	210-023
3/4" NPT(M)	210-038

Maximum Working Pressure: 5000 PSI (34.5 MPa)



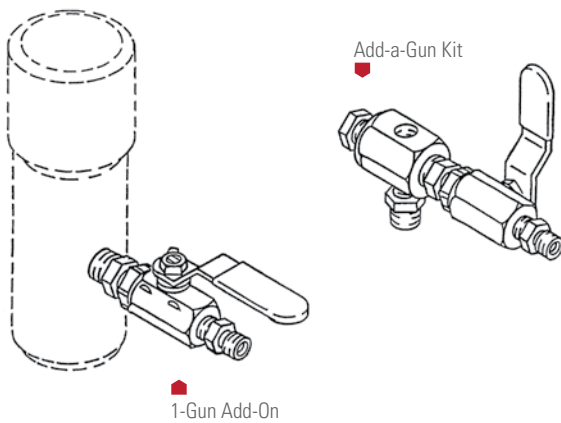

Gun Add-On Kits:

Can be used on pumps with an open 3/8" NPT port on the manifold.

	1-GUN ADD-ON		ADD-A-GUN	
	975-111 1/4" Hose	975-311 3/8" Hose	975-200 1/4" Hose	975-300 3/8" Hose
INCLUDES	PART NO.	PART NO.	PART NO.	PART NO.
Nipple, Hex	814-002	814-004	814-002	814-004
Ball Valve	940-553	941-555	940-553	941-555
Nipple, Hex	227-006	808-555	227-006	808-555
Plug, Pipe			227-033	227-033
Block, Manifold			970-100	970-100
Nipple, Hex			814-004	814-004

Maximum Working Pressure: 3600 PSI (24.8 MPa)

Multiple Gun Add-on Assemblies (1/4")

Hose connection 1/4" MPSM (M).

	975-212 2-Guns	975-213 3-Guns
INCLUDES	QTY.	QTY.
1-Gun Add-On (975-111)	1	1
Add-A-Gun Kit (975-200)	1	2

Maximum Working Pressure: 3600 PSI (24.8 MPa)

Multiple Gun Add-on Assemblies (3/8")

Hose connection 3/8" NPSM (M).

	975-312 2-Guns	975-313 3-Guns	975-314 4-Guns
INCLUDES	QTY.	QTY.	QTY.
1-Gun Add-On (975-311)	1	1	1
Add-A-Gun Kit (975-300)	1	2	3

Maximum Working Pressure: 3600 PSI (24.8 MPa)



High Pressure Ball Valve

FITTING SIZE	PSI	PART NO.
1/4"	6000 (41.4 MPa)	0533358
1/4"	7500 (51.7 MPa)	0533348
3/8"	6000 (41.4 MPa)	0533359
3/8"	7500 (51.7 MPa)	0533347

KEEP YOUR EQUIPMENT CLEAN AND WORKING FOR YOU

No matter what the sprayer – hydraulic, gear driven, gas-powered or electric – if you want a long service life you will need to care for it with the same attention you care for your own car or truck. That means changing the oil, lubricating the piston, cleaning the unit, the gun and the tip. Titan has all the products you need to keep your accessories and equipment clean and functioning in top condition.



PumpRunner ▶

PumpRunner 0286008

The PumpRunner is the ideal accessory for your piston pump. It prevents the inlet valve from drying out, ensures clean transport and reduces clean up time. Works on most high rider model sprayers.

Sprayer sold separately.

LS-10 Liquid Shield Plus™

Cleans and protects your spray system against rust and corrosion, extending the life of your pump.

▶ Includes anti-freeze protection

DESCRIPTION	PART NO.
4 oz. Bottle	314-483
1 Qt. Bottle	314-482
1 Gallon Bottle	0521418

Pump Shield™ 0297055

Cover your sprayer to prevent paint overspray from sticking to it. Keeps your sprayer looking new.



Tip Clean™ 314-207

Hour-glass design allows easy cleaning of all airless tips and safe storage. Cleaning fluid removes contamination and paint residue, ensuring best spraying results. **7 oz. (200 ml) Bottle**

Piston Lube™

Specially formulated to prevent materials from adhering to the piston rod. Suitable for use with most airless piston pumps.

DESCRIPTION	PART NO.
4 oz. Bottle	314-481
8 oz. Bottle	314-480
1 Qt. Bottle	700-926

Paint Mate™

Water-based coating additive that significantly improves atomization with HVLP sprayers without compromising the integrity of the coating.

DESCRIPTION	PART NO.
1 Qt. Bottle	0508071
1 Qt. Bottle (Case of 6)	0508069

Air Care™ 311-101

Pneumatic equipment lubricant storage protector. Contains premium additives to extend life of equipment. **1 Qt. Bottle**

Coolflo™

Hydraulic Fluid for PowrTwin™, Hydra™ and sealed hydraulic sprayers.

DESCRIPTION	PART NO.
1 Qt. Bottle	430-362
1 Qt. Bottle (Case of 12)	430-363
1 Gallon	430-361

Lubriplate™/GR-132

Specially designed for gear boxes.

DESCRIPTION	PART NO.
14 oz. Can	314-171
6 lb. Can	9870307

Part Renu™



Safely remove paint from spray guns and sprayer accessories. This non-flammable, water-based cleaner is environmentally safe, odor free and will not burn skin. Easily washes off with water.

- Starter Kit includes easy-to-use strainer

DESCRIPTION	PART NO.
1 Gallon Part Renu™	0521423
5 Gallon Starter Kit	0521010



3-Piece Gun Cleaning Kit 0550963

3-piece brush set includes an internal and external cleaning brush and a brush for the fluid tube.



17-Piece Gun Cleaning Kit 0550962

Includes:

- 4 Large Tube Brushes
- 5 Precision Mini-Twisted Brushes
- 6 Precision Cleaning Needles
- 1 Small Cleaning Rod w/Brush
- Nylon Bristle Parts Brush

Master Kit with Case 0550961

Includes:

- 6-piece Precision Needle Set
- Handle for Precision Needle
- Handle for Detail End Brush
- Paint Gun Lube, 30 ml
- 3-piece Detail End Brush (1/4", 3/8" and 1/2")
- 12" Pick-Up Tube Brush
- 5-piece Precision Mini-Twisted Brush
- Nylon Bristle Parts Brush
- Brass Power Pick-Up Tube Brush
- 1/4" HVLP Brush
- 1/2" Body Cavity Brush



HARD WORKING LINE STRIPER ACCESSORIES

WindGuard™ Spray Shield 0290623

Spray shield protects spray pattern from wind, minimizing over-spray. Works well when applying diluted athletic field marking paints. Adjustable for easy “on the fly” line width changes – 4", 6" or 8" and is easily removed from sprayer.

- Attaches to any Titan PowrLiner and most competitive models
- Spring loaded shields promote forgiveness on uneven surfaces
- Lightweight – only 5.5 lbs.



Stencil Kit

Stencil Kits

Molded of 1/8" (.15 cm) polyethylene, these stencils are very durable and lay flat on surfaces for clean and accurate marking.

STENCIL KIT 1		
	INCLUDES	PART NO.
39" (99 cm) Handicap		0290932

STENCIL KIT 2		
	INCLUDES	PART NO.
39" (99 cm) Handicap		0290933
12" (30 cm) No Parking		
12" (30 cm) Numbers 0–9		

STENCIL KIT 3		
	INCLUDES	PART NO.
42" (105 cm) Straight and Curved Arrows		0290934
39" (99 cm) Handicap		
12" (30 cm) Numbers 0–9		
4", 12" (10, 30 cm) No Parking		
4", 12" (10, 30 cm) Fire Lane		
4" (10 cm) Reserved		
4" (10 cm) Visitors		



LineSite™ Laser Pointer



Second Gun Kit

LineSite™ Laser Pointer 0290038A

Great for start/stops, curb striping, executing perfectly straight lines and training new employees. High intensity green laser is easy to see in daylight.

- Includes two lasers, mounting kit and rechargeable battery pack
- Compatible with most line strippers

Second Gun Kit

These gun kits come complete with mounting bracket, airless gun, 6' x 1/4" hose and line striping tip. Mounts on either side of 4950, 6950 and 8950 PowrLiner.

DESCRIPTION	PART NO.
S-3 Gun Kit	759-138
S-5 Gun Kit	759-038
PowrLiner 2850 Gun Kit	0290310

HandiBead™ Bead Dispenser 0290953A

Apply glass beads with consistency and accuracy. Eliminates hand tossing glass beads on stop bar or crosswalk applications.

- Adjustable diffuser can disperse material up to 15" wide
- Includes 3 nozzles (small, medium and large)





Glass Bead Dispensing Systems

Includes hopper, hose and dispenser.

DESCRIPTION	PART NO.
1-Gun Kit (4–6")	424-826
2-Gun Kit (4–6")	424-836
1-Gun Kit (12")	424-840
2-Gun Kit (12")	424-841
Add a Second Dispenser to your 1-Gun Kit Second Dispenser with Hose (4–6")	424-816

Compatible with: 4950, 4955, 6950, 6955, 8950, 8955, 4900XLT, 6900XLT and 8900XLT.
LazyLiner™ and PowrLiner™ sold separately.



SureTrak™ Floating Gun Kit



LazyLiner™ Tray

SureTrak™ Floating Gun Kit 759-120

Keeps the gun at the proper height from the surface for perfect lines over rough terrain.

- Works great on pavement, grass and turf
- Attaches to PowrLiner™ 4950, 4955, 6950, 6955, 8950 and 8955

LazyLiner Tray

Use this attachable tray system as an option for carrying around additional items.

- For use on the LazyLiner Pro and Elite

DESCRIPTION	PART NO.
LazyLiner Pro Tray (Must add bumper 0290646)	0290645Z
LazyLiner Elite Tray	0290645Z



SmartArm™ Pivot System



SmartArm™ Lift System

SmartArm™ Assembly 0290382

Built to make line adjustments and transportation quick and easy.

- Pivots down for spraying and up for transportation/storage
- Locks in at any angle for curb striping
- Adjust gun height (fan pattern) up/down with the turn of a lever
- Automatically centers spray arm for easy set-up
- Graduated to return to your preferred spray position

Striper Add-On Accessories

RECOMMENDED GUNS	
DESCRIPTION	PART NO.
LX-40 Gun	550-540
LX-80" Gun	0550030
S-3 Gun	0550060
S-5 Gun	0550070

UPGRADES	
DESCRIPTION	PART NO.
PowrLiner™ 850 Caster Release Kit	0293970
12-Gallon Hopper	759-130
Polyethylene 5-Gallon Pail Cover	759-147
Turf Kit for PowrLiners 4955–8955	759-155

Hitches and Bumpers

DESCRIPTION	COMPACT	PRO	ELITE
	PART NO.	PART NO.	PART NO.
PowrLiner 2850	----	0290043Z	0290043Z
PowrLiner 4950, 4900xlt, 6900xlt, 8900xlt	0290047Z	0290047Z	0290047Z
PowrLiner 6950, 8950	0290048Z	0290048Z	0290048Z
PowrLiner 4955, 6955, 8955	----	0290045Z	0290045Z
Graco® 3900 and Up	0290050Z	0290050Z	0290050Z
Bumper / Engine Protection Bar	----	0290646	Included

The drivers are not shipped with a hitch; use chart to identify which hitch to order.

TOOLS FOR THE PERFECT FINISH



Maxum II Gun 0524041

For maximum control and pinpoint-accurate coating delivery, the Maxum II is an excellent choice for contractors and finishing professionals that need a precise fine finishing tool.

- Ability to convert from non-bleeder to bleeder gun
- Comes standard with a #3 Proset (Needle set) and 1 Qt. cup

MAXUM II ACCESSORIES		
	DESCRIPTION	PART NO.
	Pressure-Fed 1 Qt. Cup	0524041

Projector Sets

	MAXUM II PART NO.	MAXUM ELITE PART NO.
DESCRIPTION		
#2 Proset (Fine Finish)	0276254	0524293
#3 Proset (All-Purpose)	0276227	0524294
#4 Proset (High Output)	0276228	0524295
#5 Proset (High Output)	0276229	0524296
#6 Proset (High Output)	0276245	0524297
#7 Proset (Highest Output)	0524211	0524298



Maxum II Gun

Maintenance and Repair Kits

MAINTENANCE KITS

DESCRIPTION	MAXUM II PART NO.	MAXUM ELITE PART NO.
Deluxe Kit	0279941	0524189
Standard Kit	0279942	0524188

GUN REPAIR KITS / PARTS

DESCRIPTION	PART NO.
Replacement Check Valve Assemblies (3-Pack)	0297051
Check Valve Seals (10-Pack)	0276257
Gun Repair Kit for Maxum Elite Gun	0524187
Spring Plate Assembly	0275250
Gun Repair Kit for 3100 Gun (Siphon and Pressure-Fed)	0550985
Gun Repair Kit for 3100 Gun (Gravity Fed)	0552916

REPLACEMENT TURBINE FILTERS

DESCRIPTION	PART NO.
Airfilter Kit CapSpray 8500	0279938

Accessories

CUPS AND ACCESSORIES

DESCRIPTION	PART NO.
1-Qt. Cup Assembly with Swivel Tube	0277183
1-Qt. Replacement Cup	0275573
2-Qt. Remote Cup System (Complete)	0524203
Air-Tight Lid for Paint Cups (Retains paint for long periods)	0508124
Cup Assembly without Swivel Tube	0275247
600 ml HVLP Top Feed	0524211
Gravity Cup Assembly with Stand	0524045
White, 1 Qt. Cup Gaskets, Hot Solvents (6-pack)	0297052
White, 2 Qt. Cup Gaskets, Hot Solvents	0524337

HOSES AND FITTINGS AIR HOSE

DESCRIPTION	PART NO.
20' x 3/4" Flex Air Hose	0275276
25' x 3/4" Flex Air Hose	0275277
30' x 3/4" Flex Air Hose	0277337
30' Air Hose	0295689
5'x 3/4" Air Whip Hose	0524405A
30' x 3/8" Material Hose	0277348
Quick Disconnect (F) Turbine	0275625

2 Qt. Remote Cup 0524203

Transform your turbine system into a high capacity sprayer without adding the cost and weight of a bulky air compressor.

For use with Capspray 75–115 sprayers. 5' Air whip hose sold separately.



PowerTex™
Gun

Texture Hopper Gun and Accessories

DESCRIPTION	PART NO.
PowerTex™ Gun	0524039
PowerTex Hopper with O-Ring	0520206
PowerTex Air Adjustable Valve	0524966
Air Hose Adapter Assembly	0520211
PowerTex Nozzle Kit	0524567

TOOLS FOR THE PERFECT FINISH

Fine finishing depends largely on the skill of the finisher but it also depends on the quality of the finishing tool. The most perfect finish can be possible only if the professional uses the best quality designed and manufactured equipment—in this case, guns, pressure pots, cups and accessories that deliver a perfect finish the first time—every time.

Pressure-Fed Spray Guns

- ▶ Rugged, forged aluminum alloy body
- ▶ All guns are 100% tested to ensure reliability
- ▶ Compact, comfortable body design
- ▶ Precision air cap design
- ▶ Superior atomization for a first class finish
- ▶ Large fluid and air control knobs for easy adjustment
- ▶ Stainless steel fluid passages
- ▶ Smooth 2-stage trigger pull means less fatigue



SERIES 3100H HVLP

AIR REQUIREMENTS: 8.8 CFM @ 25–43 PSI

DESCRIPTION (NNK)	PART NO.
1.0 mm	0550986
1.2 mm	0550987
1.4 mm	0550988
1.7 mm	0550991
2.0 mm	0550814
2.4 mm	0550989

SERIES 3100H CONVENTIONAL

AIR REQUIREMENTS: 7.0 CFM @ 30–60 PSI

DESCRIPTION (NNK)	PART NO.
0.8 mm	0550995
1.1 mm	0550994
1.4 mm	0550993
1.8 mm	0550997
2.0 mm	0550998
2.4 mm	0550949

Pressure-Fed Replacement NNK

SERIES 3100 HVLP

1 Qt. Cup Pressure-Fed Guns

DESCRIPTION	PART NO.
1.0 mm	0550977
1.2 mm	0550976
1.4 mm	0550975



SERIES 3100 CONVENTIONAL

1 Qt. Cup Gravity-Fed Guns

DESCRIPTION	PART NO.
0.8 mm	0550980
1.1 mm	0550979
1.4 mm	0550978

Pressure Pots

2.5 GALLON

DESCRIPTION (NNK)	PART NO.
Pot only: Includes Air and Fluid Regulators with Pressure Gauges	0550949
HVLP Gun, 1.0 mm NNK Complete with 3100 Gun and 25' Air and Fluid Hose	0550951
Conventional Gun 0.8 mm NNK	0550950

PNEUMATIC AGITATION

Includes Air and Fluid Regulators with Pressure Gauges

DESCRIPTION	PART NO.
2.5 Gallon	0550953
5 Gallon	0550948

All 5 gallon pots come with a stainless steel liner.

MANUAL AGITATION

Includes Air and Fluid Regulators with Pressure Gauges

DESCRIPTION	PART NO.
2.5 Gallon	0550952
5 Gallon	0550947

All 5 gallon pots come with a stainless steel liner.

2 Qt. Remote Cup 0550956

Includes 2 Qt. cup, 5' hose, regulator and gauge.



Remotes

2 QUART REMOTE SYSTEM

Includes Air and Fluid Hoses and a 3100 Gun

DESCRIPTION	PART NO.
2 Qt. Remote 3100 HVLP Gun, 1.0 mm NNK	0550958
2 Qt. Remote 3100 Conventional Gun, 0.8 mm NNK	0550957

Air Hose to Compressor sold separately.

Pressure-Fed Accessories

DESCRIPTION (NNK)	PART NO.
2 Qt. Cup Gasket	0550955
2.5 Gallon Cup Gasket	0552308
Gravity Cup Gasket (5-pack)	0552918
Mini Gravity Cup Gasket (5-pack)	0552920
2.5 Gallon Liner	0552353



Gravity-Fed Airspray Guns

SERIES 3100 HVLP

AIR REQUIREMENTS: 9.0 CFM @ 15–20 PSI

DESCRIPTION (NNK)	PART NO.
1.8 mm (0.070")	0552271
2.0 mm (0.078")	0552270
1.4 mm (0.055")	0552305
1.4 mm (0.055") w/plastic cup	0552345

SERIES 3100 CONVENTIONAL

AIR REQUIREMENTS: 7.0 CFM @ 30–43 PSI

DESCRIPTION (NNK)	PART NO.
1.8 mm (0.070")	0552273
2.0 mm (0.078")	0552272
1.4 mm (0.055")	0552304
1.4 mm (0.055") w/plastic cup	0552344

AIRSPRAY MINI

AIR REQUIREMENTS: 3.5 CFM @ 30–43 PSI

DESCRIPTION (NNK)	PART NO.
0.8 mm (0.031")	0550983
1.0 mm (0.043")	0552283
1.2 mm (0.043")	0552284

Gravity-Fed Replacement NNK

SERIES 3100 HVLP

For use with 1 Qt. Cup Gravity-Fed Guns

DESCRIPTION	PART NO.
1.4 mm (0.055")	0552274
1.8 mm (0.070")	0552275
2.0 mm (0.078")	0552276
2.5 mm (0.098")	0552277

SERIES 3100 CONVENTIONAL

For use with 1 Qt. Cup Gravity-Fed Guns

DESCRIPTION	PART NO.
1.4 mm (0.055")	0552278
1.8 mm (0.070")	0552279
2.0 mm (0.078")	0552280
2.5 mm (0.098")	0552281

SERIES 1500

Conventional Only

DESCRIPTION	PART NO.
0.8 mm (0.031")	0552286
1.0 mm (0.043")	0552287
1.2 mm (0.043")	0552288



Gravity-Fed Accessories

DESCRIPTION	PART NO.
600 ml Cup	0552343
125 ml Cup (Mini Gun Only)	0552342

Siphon-Fed Airspray Guns

SERIES 3100 HVLP (Includes Aluminum Cup)

AIR REQUIREMENTS: 8.8 CFM @ 25–43 PSI

DESCRIPTION (NNK)	PART NO.
1.4 mm (0.055")	0550868
1.7 mm (0.066")	0550866
2.0 mm (0.078")	0550864
2.4 mm (0.094")	0550862

SERIES 3100 CONVENTIONAL

AIR REQUIREMENTS: 7.0 CFM @ 30–60 PSI

DESCRIPTION (NNK)	PART NO.
1.4 mm (0.055")	0550869
1.8 mm (0.070")	0550867
2.0 mm (0.078")	0550865
2.4 mm (0.098")	0550863

Siphon-Fed Replacement NNK

HVLP

For use with 1 Qt. Cup Siphon-Fed Guns

DESCRIPTION	PART NO.
1.4 mm (0.055")	0550967
1.7 mm (0.066")	0550968
2.0 mm (0.078")	0550969
2.4 mm (0.094")	0550970

CONVENTIONAL

For use with 1 Qt. Cup Siphon-Fed Guns

DESCRIPTION	PART NO.
1.4 mm (0.055")	0550971
1.8 mm (0.070")	0550972
2.0 mm (0.078")	0550973
2.5 mm (0.098")	0550974



1 Qt. PTFE®-Coated Cup and Assembly



Siphon-Fed Accessories

DESCRIPTION	PART NO.
1 Qt. PTFE®-Coated Cup and Assembly	0550872
1 Qt. Aluminum Cup and Assembly	0550873





Subject to modifications 03/16 JB70377B / SL40279



Write to
IntTechService@titantool.com
for complete warranty information.

All information contained in this brochure is based on the latest information available at the time of printing. Titan reserves the right to make changes at any time, without notice. Due to continuous innovation, specifications may progressively change. Contact one of our dependable sales reps or call our dedicated customer service team for more information.

Titan Tool | 1770 Fernbrook Lane | Minneapolis, MN 55447 | international@titantool.com